

QuayLife

ISSUE 6 / SPRING 2022

INSIDE

**Twin Province:
Gin Distillery, Bar
& Restaurant Group
to open in 2022**

**Win a Brompton Bike for
12-months**

Just launched:

**Lyons Dock
apartments to rent**

**GREENFORD
QUAY**

Welcome to QuayLife Spring 2022

Lyons Dock apartments excitingly open their doors to residents for rent in May, we have announced an opening month for Gin Distillery, Bar, & Restaurant: Twin Province later in 2022, and

Brompton Bikes's eggs-quisite Easter Egg Hunt with the chance to win great prizes. Plus, an interview with Greenford Quay's Dan Collins. We hope you enjoy the sixth edition of QuayLife.

YOUR SITE TEAM IS HERE FOR YOU, WHATEVER YOUR QUERY.
EMAIL TILLERMANS@GREENFORDQUAY.COM OR CALL 0203 131 1800

CommunityLife

Find out what's happening in and around Greenford Quay



ARE YOU PICKING UP WHAT WE'RE FOLDING DOWN?

We have been busy putting together the finishing touches to our Summer Series. In the meantime, put a spring in your step with a promo code Brompton Bikes. Residents are eligible to reserve and ride bikes available from the dock located here at Greenford Quay for free.

Use the promo code 'Greenfordquay' when registering, and become a member for just £1 and receive £100 hire credit, available for 12-months.*

GET READY FOR THE EGG HUNT OF THE SEASON HERE AT GREENFORD QUAY!

Brompton Bicycles will be running an Egg Hunt over the Easter period via their Hire docks, including ours onsite. You could be in with a chance to win your very own Brompton bike to keep for 12 months, amongst many other great prizes. To join:

1. Download the Brompton Bike Hire App
2. Register your details
3. Keep an eye on our social channels for updates
4. Happy hunting

*NB: Offer is limited to one membership per household.

NEW: LYONS DOCK APARTMENTS FROM MAY 2022

Rethink the way you rent



With its idyllic setting along the Grand Union Canal, Greenford Quay's Lyons Dock is the latest addition to the Quay. Available for rent from May 2022, Lyons Dock features a

stunning design inspired by the historic stately homes of Greenford. Expect a gym, private cinema, private residents' dining space and more.

TO LEARN MORE, OR TO GET IN TOUCH WITH THE LYONS DOCK TEAM, VISIT: [GREENFORDQUAY.COM/LYONS-DOCK-NEW-BUILD](https://www.greenfordquay.com/lyons-dock-new-build)

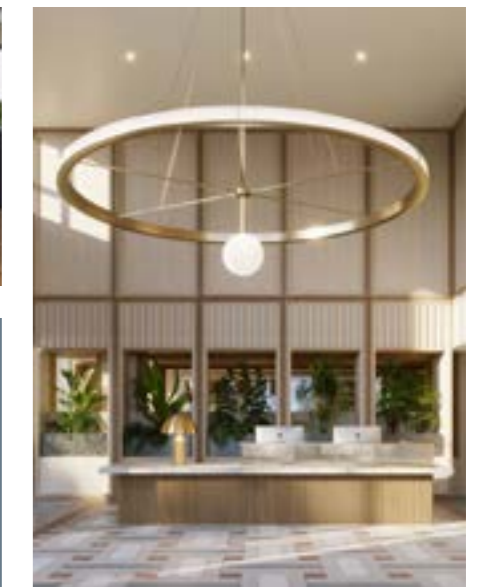

"We wanted to bring to life that combination of Greenford and London, and being on the line between the city and the countryside of Horsenden Hill."

ALICE TAGG
PART OF THE DESIGN TEAM FOR LYONS DOCK

Spotlight

Community enthusiast, local event-goer, property professional – Assistant Community Manager Dan Collins shares a few of his favourite things about working at Greenford Quay (GQ) with *QuayLife*.

"No two days are the same at Greenford Quay, and I love it!"



QuayLife: So Dan, why GQ?

Dan: From building management, day-to-day operations of Tillerman's Court to placemaking events with our residents and local retail units – each day is unique. Working

on projects that support the local community is very special.

QuayLife: Fantastic to hear. What is community life like at GQ?

Dan: In one word: vibrant!

QuayLife: Do tell, what can the locals expect this Spring at GQ?

Dan: Lots of fun, interactive activities happening over the coming months. With Covid-related restrictions now lifted, live events are back in a big way! Keep an eye out for our amphitheatre pop-up cinema nights, live music, food stalls, to activities focused on giving back to the community, such as litter picking and food drives.

QuayLife: Can't wait! What else do you think our residents enjoy most at GQ?

Dan: Our cinema room, games area, and other communal spaces. The facilities

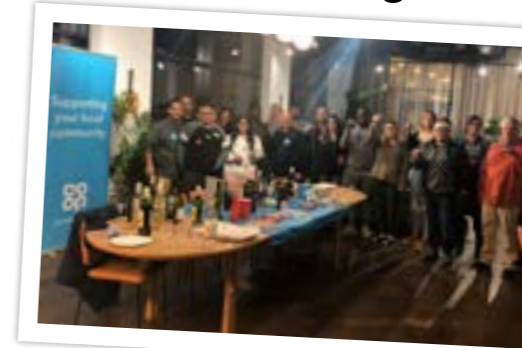

are in full swing. We also run resident events, like quiz and themed F&B nights, especially now that we can socialise as before - it's a breath of fresh air. But, of course, none of this could be

possible without our dedicated onsite team, with our facilities occupancy increasing from 60% in August 2021 to an incredible 86% today.

QuayLife: And finally, the most memorable moment in your role at GQ?

Dan: Meeting and socialising with our residents at a recent Wine & Cheese night. It's a standout because it was one of the first events in two years not impacted by restrictions – a great physical reminder of what we are working towards and the environment we provide for residents.

RetailWatch



WHAT'S NEW AT TILLERMAN'S COURT

We are thrilled to welcome Gin Distillery, Bar and Restaurant Group, Twin Province to our community. Brought to you by Shane Long and Nate Brown, Twin Province's Bar and Restaurant is forecast to open its doors at Tillerman's Court in September this year, followed by the Gin Distillery – date to be confirmed.



SPRING CLEANING AT PAWS IN THE CITY

Paws in the City, our premium veterinary healthcare provider, is taking a short break while their space undergoes an internal fitout. They are scheduled to reopen their doors by May 2022. To learn more, visit: pawsinthecityx.com

DevelopmentUpdate



Lyons Dock Launch

The team are excited to announce Lyons Dock is nearing completion with the first units due to be occupied from May 2022. Over the next three months, the remaining scaffolding surrounding the building will be removed, opening up the development.

Separate landscaping works surrounding the building are currently under construction and will progressively complete across the middle of this year, starting on the northside. Once completed, these works will provide direct access between Greenford Quay

and Oldfield Lane North. This will allow residents to freely travel through the development and straight onto the canalside pathway leading up and down the Grand Union Canal.

To ensure safe passage for the community, the footpath adjacent to the Lyons Dock will remain closed with a temporary pedestrian crossing at Oldfield Lane North road bridge over the canal.

This footpath will be upgraded in the coming months once the building nears completion.

IF ANYONE HAS ANY CONCERNS OR QUESTIONS, PLEASE CONTACT TILLERMANS@GREENFORDQUAY.COM